



Regal Princess®

A relaxed, rejuvenating retreat at sea



Best Atrium Design
— *Travel Weekly*

The Atrium & Piazza

Every detail of the new Royal Princess & Regal Princess has been designed to enhance the atmosphere of which our loyal passengers have grown accustomed.

From the breathtaking Atrium & Piazza — now over 50 percent larger than our other ships' Atriums and featuring exciting new eateries — to elegant decor specifically chosen to reflect the warmth and sophistication that's synonymous with Princess Cruises, to exciting new signature features like The SeaWalk®, a dramatic glass-bottomed walkway which *USA TODAY* calls one of the "Top Gee-Whiz Features at Sea"— the next generation of the Princess fleet is sure to impress.

Recognized by *Cruise Critic* as one of the "Most Popular Ships at Sea," our newest ships have everything you need to return to the world renewed and rejuvenated.

"Top Gee-Whiz Feature at Sea!"
— *USA TODAY*



The SeaWalk®

See more

Take a virtual video tour of the expanded, award-winning Atrium at princess.com/royalprincess



The Sanctuary

The Sanctuary

Leave stress at the door when you enter The Sanctuary, our blissful signature haven just for adults. This sought-after tranquil retreat features luxurious private VIP cabanas with refrigerators and flat-screen TVs — exclusively on Royal Princess & Regal Princess. Simply reserve one of these new cabanas for your own personal dose of relaxation as our Serenity Stewards serve you spa fare and refreshing drinks.

The Lotus Spa®

When you're not indulging in a massage, facial or other relaxing treatment, check out what's new in the Lotus Spa, Gold Magellan Award winner for Best Spa Design from *Travel Weekly*. An exclusive area of the spa, The Enclave at Lotus Spa is a premier amenity-filled thermal suite featuring a hydro-therapy pool, a Laconium, a Caldarium, a Turkish hammam and more.

NOTE: Venues are subject to a nominal charge and subject to change.

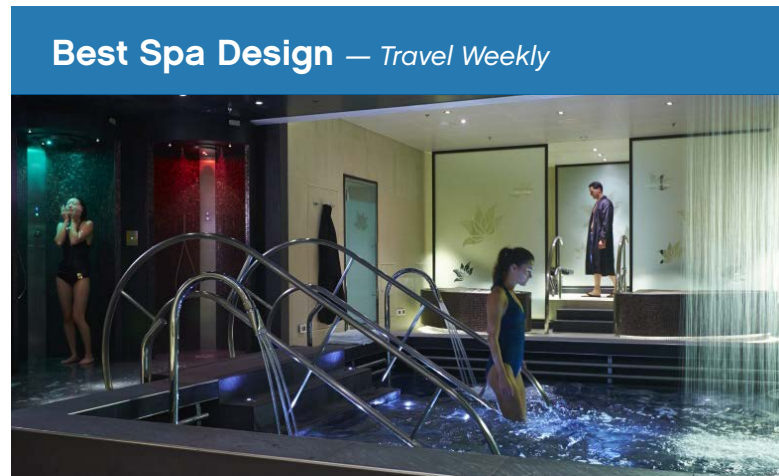

The Enclave at Lotus Spa®



Couples treatment room at The Lotus Spa®

Something to suit every taste



Bellini's Bar

Bars and lounges

Soak up the lively atmosphere of the Atrium with a delicious glass of bubbly in our new Italian-inspired Bellini's Bar. Or, return to the comfort of familiar favorites nearby like Crooners or the Wheelhouse Bar.

Pools

Take a relaxing dip in our top-deck fresh water pool, Silver Magellan Award winner for Best Pool Design from *Travel Weekly*, or reserve a plush private cabana with a dedicated steward next to our new adults-only Retreat Pool.

Boutiques

Treasures from around the world await in The Atrium's boutiques — such as our new gift shop, Celebrations, perfect for those who want to commemorate any celebration or well-deserved indulgence.

Sports & fitness

Get a workout in our state-of-the-art fitness center. Or for those who like to be in the great outdoors, head up to the Sports Court and jogging track on Deck 18 — which also features a circuit of outdoor exercise equipment.



Wheelhouse Bar

Youth and teen centers

Passengers ages 3 to 17 will enjoy many exciting onboard activities. There's everything from dedicated outdoor spaces, to video game stations, a large movie screening area, arts and crafts, and a DJ booth!



Dazzling Water & Light Show and Movies Under the Stars®

Movies Under the Stars®

Our signature outdoor theater will astound you on Royal Princess & Regal Princess with our largest high-definition screen and best sound system ever. And don't miss our magical nighttime Water & Light Show, transforming the top deck with music, lighting effects and dancing fountains.

NEW Princess Live!

The first of its kind at sea, Princess Live! is our new onboard TV studio presenting broadcast-ready events including interactive game shows, unplugged musical performances, late night comedy and the filming of the ship's daily morning television program, "The Wake Show."

The Princess Theater

Take your seat in the enhanced Princess Theater, our largest yet, offering signature production shows and performances with sophisticated architectural lighting and high-definition screens.

Vista Lounge

Choose from diverse activities including enrichment lectures, popular fine art auctions, and live dance bands in the Vista Lounge — offering comfortable seating, exceptional entertainment, and cutting-edge lighting and sound.

Club 6 and Princess Casino

Step out of the lively Princess Casino and into contemporary Club 6, our trendy nightclub. A first on Princess, this cool new lounge has the perfect vibe whether you want to dance or relax with a fun specialty cocktail.



Princess Live!



The Princess Theater

Fresh flavors throughout the ship

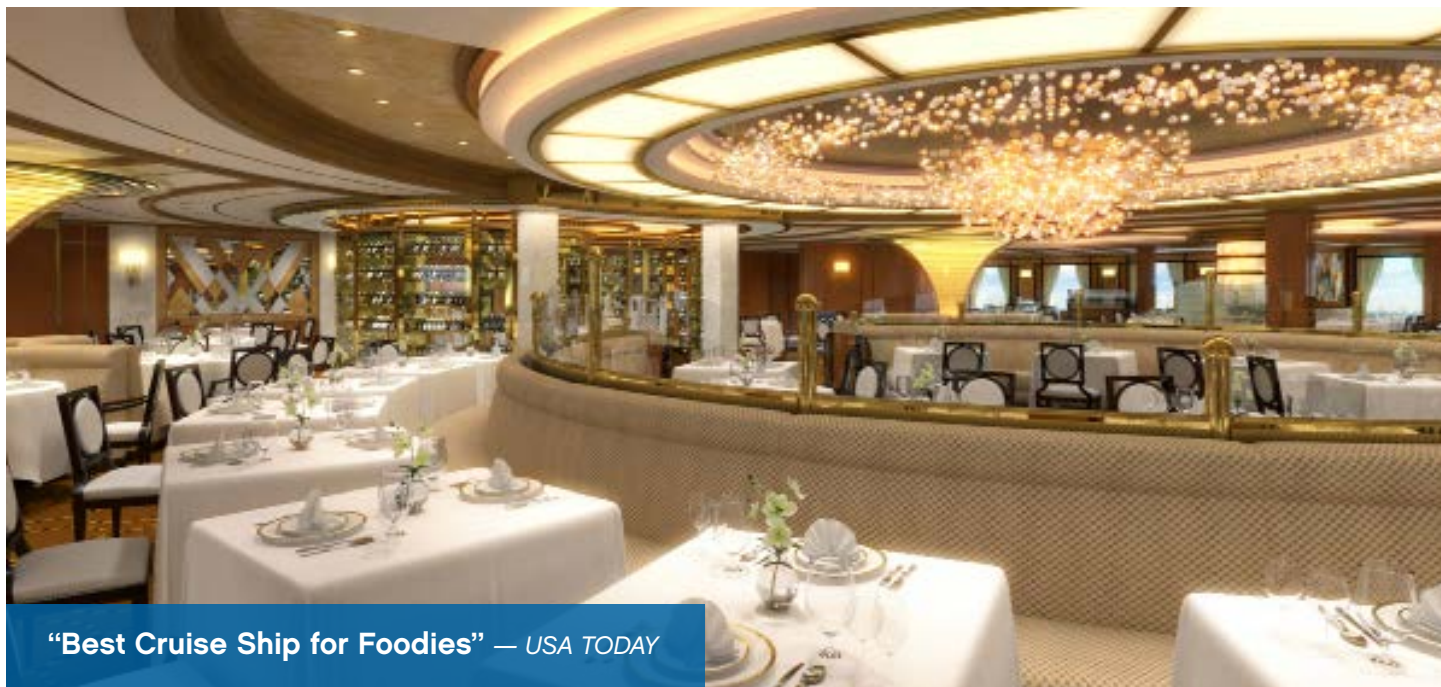

“Best Cruise Ship for Foodies” — USA TODAY

Elegant dining rooms

Traditional Dining Room

The aft Allegro Dining Room will feature another first at sea — the Chef’s Table Lumiere. Indulge in this exclusive dining experience in a sublime setting, featuring a custom-made glass table surrounded by a curtain of light.

Anytime Dining Rooms

Royal Princess & Regal Princess offer two comfortably-elegant Anytime Dining rooms to dine with whomever and whenever you choose. And new to the sister ships is the opportunity for private dining experiences in a striking circular wine cellar room.

Sabatini’sSM

For a memorable dining experience, visit our Tuscan-inspired specialty restaurant, Sabatini’s, serving authentic Italian dishes with the freshest ingredients from its à la carte menu.

Crown GrillSM

Dine at Crown Grill, a truly special dining experience where chefs custom-prepare fresh seafood, such as lobster, scallops, clams and mussels, and cooked-to-order Sterling steaks and chops.

NOTE: Select venues are subject to a nominal charge and may change.



Chef’s Table Lumiere



Sabatini’sSM

See more

Explore all the dining options Royal Princess & Regal Princess have to offer at princess.com/royalprincess



Ocean Terrace Seafood Bar

NEW Ocean Terrace Seafood Bar

For our seafood lovers, the tempting new Ocean Terrace Seafood Bar features the pearls of the ocean, fresh from the sea — including sushi, sashimi, oysters and more delicious seafood fare.

The International Café

A signature feature of our ship's Piazzas, The International Café has even more available seating from which to enjoy fresh-baked pastries, specialty coffees and delectable desserts.

Vines Wine Bar

Vines Wine Bar is the perfect place to enjoy your favorite glass of wine and a selection of regional snacks, including Spanish tapas and Venetian cicchetti.

NEW Gelato

For an enticing dessert or afternoon delight, our new gelateria offers many tempting treats! Designer sundaes, sweet crespelle, creamy fruit smoothies, frosty shakes, and delightful waffle ice cream cones!

Alfredo's Pizzeria

Just one of a few ships to offer Alfredo's pizzeria, Royal Princess & Regal Princess pair an expanded menu and more spacious seating with our complimentary hand-tossed Neapolitan-style pizza, served hot out of the oven.

Horizon Court

The newly designed Horizon Court has already been named one of the "Best Cruise Ship Buffets at Sea" by *USA TODAY* and offers a wide selection of quick meals and snacks, in addition to a hibachi grill, a rotisserie, a taco station and a make your own sandwich station.



Gelato



"Best Cruise Ship Buffet at Sea"
— *USA TODAY*

Horizon Court

NEW The Pastry Shop at Horizon Court

The Pastry Shop — the largest of its kind at sea — is a dedicated space with its own unique design, décor, function and seating area offering an amazing variety of specialty treats, complemented by a full range coffee bar.

Special touches make all the difference

Every Royal Princess & Regal Princess stateroom includes:

- NEW** • Contemporary and inviting decor
- 100% Egyptian linens
- Pillow-top mattress
- In-room safe
- Refrigerator
- NEW** • 37" flat screen television with movies, cable and satellite programming
- NEW** • Shower with adjustable height, hand-held massage shower head
- Upgraded hair dryer
- Fresh fruit (available upon request)
- Bathroom sundries

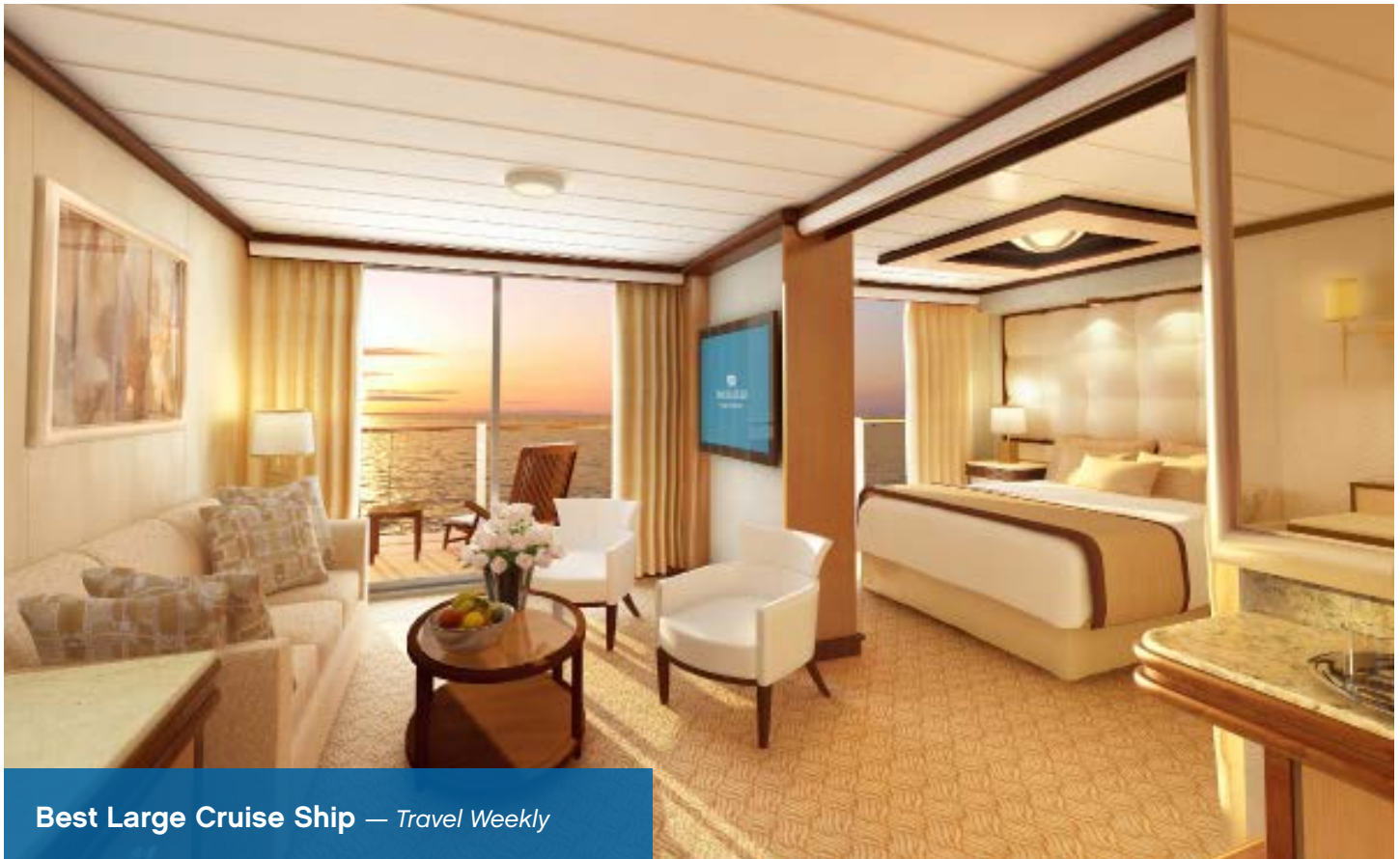

Suite with balcony

A spacious suite with balcony includes all the amenities of a mini-suite, plus incredible premiums including: two 42" flat screen televisions, separate bathtub and shower, marble floors and countertops, access to the dedicated Concierge Lounge, a choice of three comfortable mattress options, a soundstation dock for your iPod, complimentary laundry and professional cleaning services, and web access in the Internet Café.

See more

Get an exclusive glimpse into the new staterooms at princess.com/royalprincess

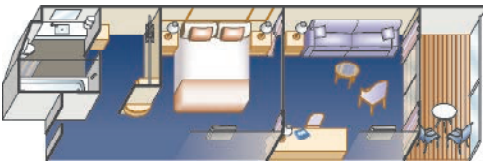

Mini-suite with balcony

Substantially larger than a balcony stateroom, a mini-suite includes all the same amenities of a balcony stateroom, plus a welcome glass of champagne, separate seating area, sofa bed, two flat screen televisions, marble-top furniture, a spacious closet and bathroom tub.

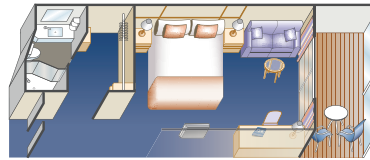

NEW Deluxe balcony

A larger version of a balcony stateroom includes all the same amenities, plus more space and a comfortable sofa bed to relax and rejuvenate. This stateroom also offers some of the same amenities found in a mini-suite stateroom, including upgraded bathroom amenities, waffle bathrobe, terry cloth towels, and an upgraded duvet insert.

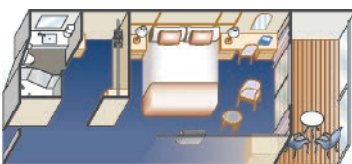

Balcony

This impressive stateroom offers the elegance of a balcony with fine patio furniture. It offers all the amenities of an interior stateroom, plus a spacious closet and desk.

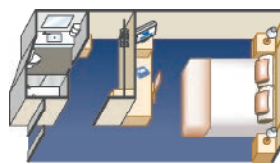

Interior

Our interior stateroom is a great value. It features the option of either two twin, or one queen-sized bed. Other amenities include a refrigerator, television, closet and bathroom with shower.

Regal Princess®

Passenger Capacity: 3,560
 Length: 1,082 ft.
 Gross Tonnage: 142,229
 Enters Service: 2014

Royal Princess®

Passenger Capacity: 3,560
 Length: 1,082 ft.
 Gross Tonnage: 142,229
 Inaugural Cruise: June 16, 2013
 Christened by: Her Royal Highness The Duchess of Cambridge

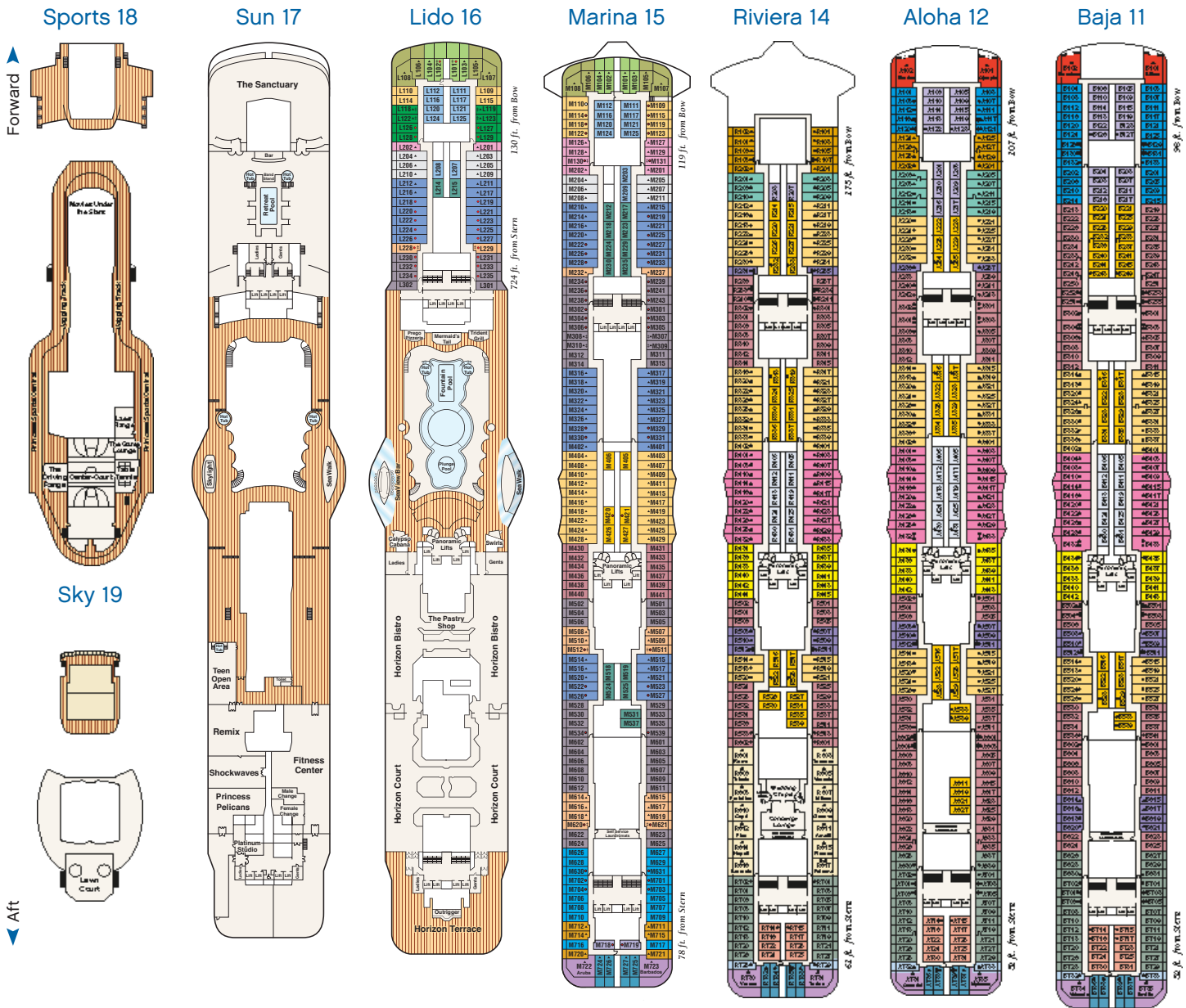
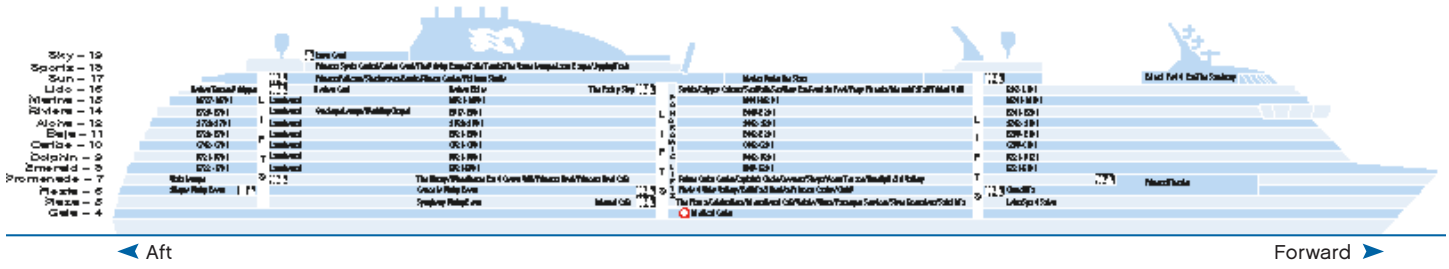

See more

For detailed deck plans & virtual tours, visit: princess.com/royalprincess

Stateroom Description

SUITE

- S2 Owner's suite** Aft (Marina, Riviera, Aloha, Baja, Caribe, Dolphin, Emerald)
- S4 Penthouse suite** Mid-aft (Riviera)
- S5 Premium suite** Forward (Aloha, Baja, Caribe, Dolphin)

MINI-SUITE

- M6 Premium** Forward (Lido, Marina)
- MA Mid-ship** (Riviera, Aloha, Baja, Caribe)
- MB Mid-forward, Mid-aft** (Riviera, Aloha, Baja, Caribe), Mid-ship (Marina)
- MC Mid-forward, Mid-aft** (Lido, Marina)
- ME Forward** (Riviera, Aloha)
- MF Forward** (Lido, Marina)

DELUXE BALCONY

- D4 Premium** Aft (Marina, Riviera, Aloha, Baja, Caribe, Dolphin, Emerald)
- DA Mid-ship** (Dolphin)
- DB Mid-forward, Mid-aft** (Riviera, Aloha, Baja, Caribe, Dolphin)

DELUXE BALCONY (CONT.)

- DC Mid-forward, Mid-aft** (Lido, Marina, Emerald)
- DD Aft** (Riviera, Aloha, Baja, Caribe, Dolphin)
- DE Forward** (Riviera, Aloha, Dolphin), Aft (Marina, Emerald)
- DF Forward** (Lido, Marina, Emerald)
- DV Obstructed view** Mid-ship (Emerald)
- DW Obstructed view** Mid-forward, Mid-aft (Emerald)
- DZ Obstructed view** Forward (Lido, Marina, Emerald)

BALCONY

- BA Mid-ship** (Riviera, Aloha, Baja, Caribe, Dolphin)
- BB Mid-forward, Mid-aft** (Riviera, Aloha, Baja, Caribe, Dolphin), Mid-ship (Marina)
- BC Mid-forward, Mid-aft** (Lido, Marina)
- BD Aft** (Riviera, Aloha, Baja, Caribe, Dolphin)
- BE Forward** (Aloha, Baja, Caribe, Dolphin), Aft (Marina, Emerald)

BALCONY (CONT.)

- BH Forward** (Lido, Emerald)
- BU Obstructed view** Mid-ship (Emerald)
- BW Obstructed view** Mid-forward, Mid-aft (Emerald)
- BY Obstructed view** Aft (Emerald)
- BZ Obstructed view** Forward (Lido, Marina)

INTERIOR

- IA Mid-ship** (Riviera, Aloha, Baja, Caribe, Dolphin)
- IB Mid-forward, Mid-aft** (Riviera, Aloha, Baja, Caribe, Dolphin), Mid-ship (Marina, Emerald)
- IC Mid-forward, Mid-aft** (Lido, Marina, Emerald)
- ID Aft** (Riviera, Aloha, Baja, Caribe)
- IE Forward** (Riviera, Aloha, Baja, Caribe, Dolphin), Aft (Marina)
- IF Forward** (Lido, Marina, Emerald)

- Wheelchair-accessible stateroom; shower only
- Will accommodate third and fourth person
- ▲ Will accommodate third person
- ‡ Balcony door blocked when upper berth is in use.

Note: Some areas of the ship are not accessible to wheelchairs and scooters. Distances shown are from the bow (forward) to stern (aft) to the nearest stateroom. Stateroom views are considered unobstructed unless noted otherwise. Obstructions do not include certain nautical items like handrails, dividers or ship hardware. For balcony staterooms, the view is determined from the perspective of the balcony railing. Balconies may have either solid steel or toughened glass railing. Call 1-800-774-6237 for more information.

Note: Deck plans are for Royal Princess only. Deck plans for Regal Princess may vary, including an aft pool on Lido 16.

Caribe 10

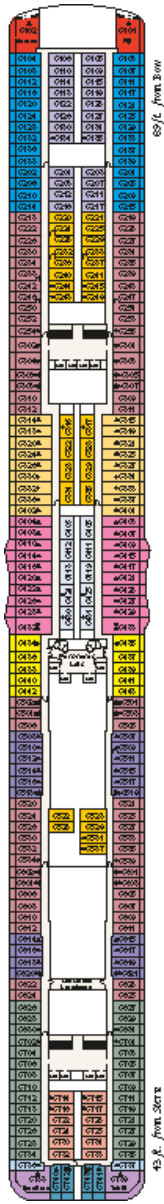

Dolphin 9

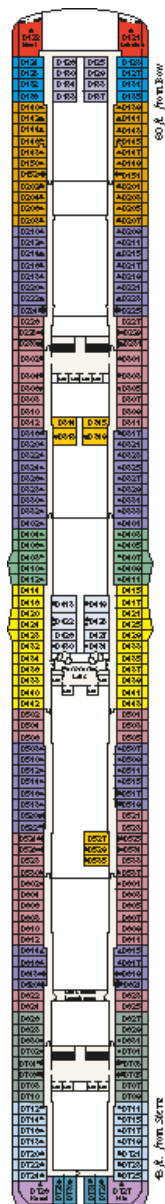

Emerald 8

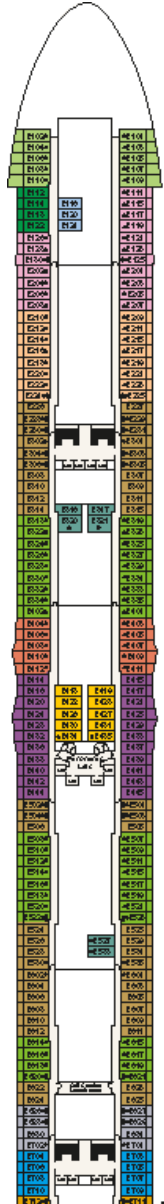

Promenade 7

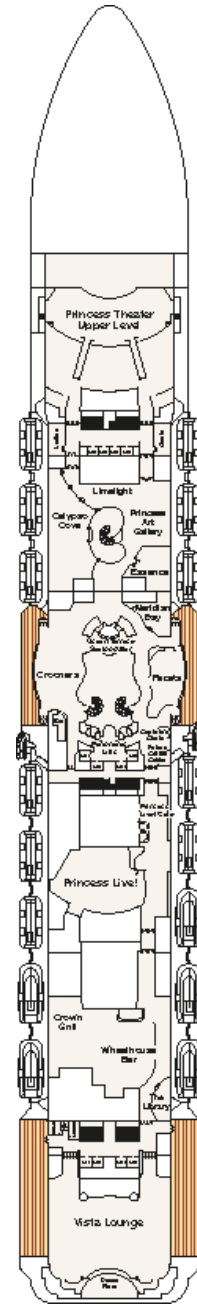

Fiesta 6

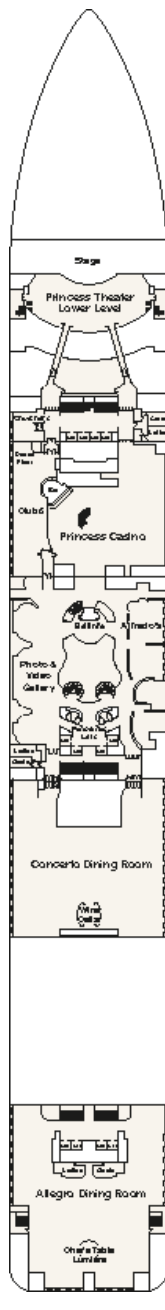

Plaza 5

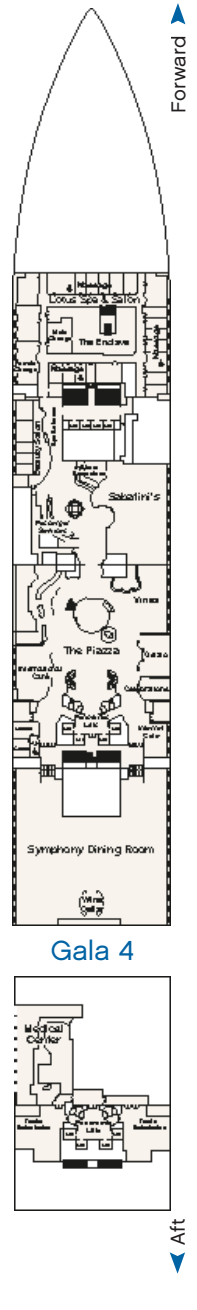

Forward ↑

Aft ↓

Gala 4

